

Plat Book-R-Page 169

5.82
3492
3492
384

169

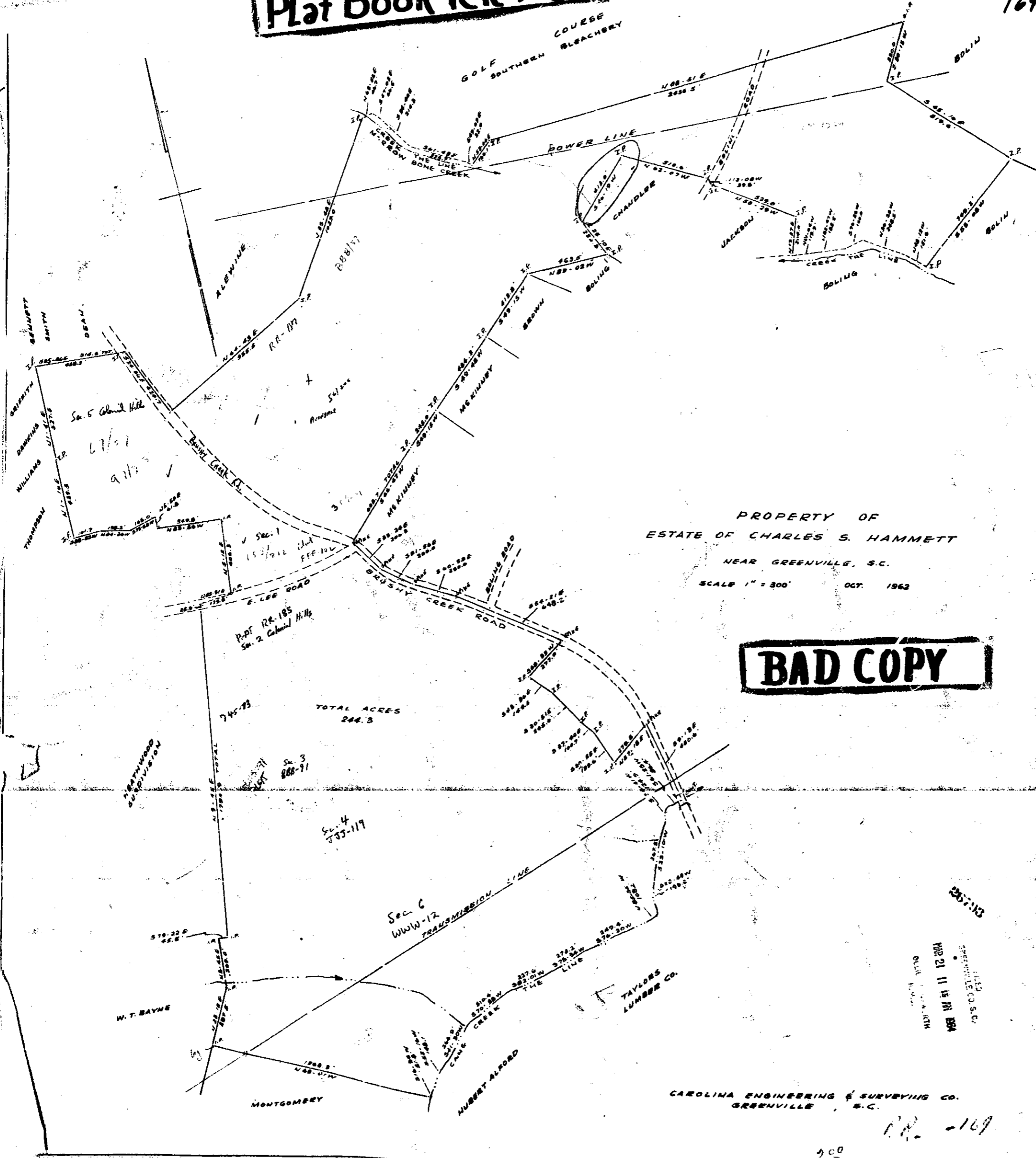

PROPERTY OF
 ESTATE OF CHARLES S. HAMMETT
 NEAR GREENVILLE, S.C.
 SCALE 1" = 300' OCT. 1962

BAD COPY

See plat 745-85

FILED
 GREENVILLE CO. S.C.
 OCT 21 11 15 AM 1962
 OLLIE H. BROWN, R.M.

CAROLINA ENGINEERING & SURVEYING CO.
 GREENVILLE, S.C.

169

30713 31 Hand G 4
 RR 169.1112A
 169